

## HOW TO FIND US ...

We're quite easy to find! We're located at Unit #309 5455 152nd Street, Surrey, B.C. (please note: we're on the West side of 152nd Street) Phone: 604 575 6911 Toll-free: 1-866-575-6911

That's just west of Cloverdale, near the intersection of Highway #10 and 152nd Street. If you're familiar with the area, we're located a block south of where the Rodeo Burger Drive-In used to be, on the West side of 152nd Street. See the map below for more information.

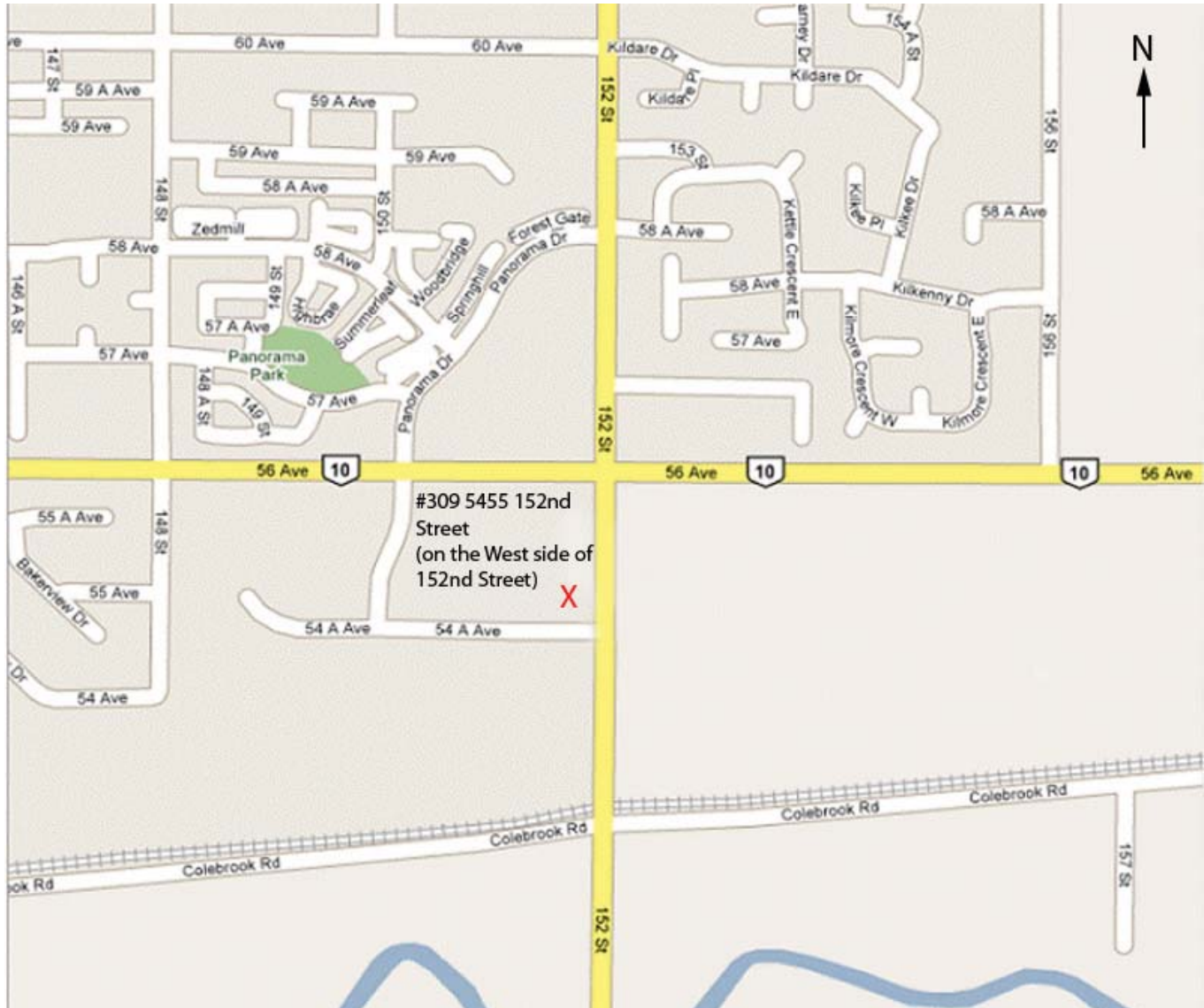

SEE THE NEXT PAGE FOR DRIVING INSTRUCTIONS ...

INSIGHTFUL ➤ INTIMATE ➤ INFORMATIVE ➤ INSPIRED

## HOW TO FIND US ...

### **From White Rock**

Travel north on 152nd Street. Turn left at 54th Avenue and we're the 1st building on your right.

### **From Langley**

Travel on #10 West (aka 56th Avenue) until you get to 152nd. Turn left (South) at 152nd Street and we're the second 3-storey commercial building on your right (both buildings use the same driveway).

### **If you're traveling Eastbound on Highway #1**

Exit at 152nd Street southbound. On a weekday, it will take approximately 20 minutes to travel down 152nd Street to our office from highway #1.

### **If you're traveling Westbound on Highway #1**

Exit at 104th Avenue and follow 104th until you get to 152nd Street. Turn left (South) onto 152nd Street. On a weekday, it'll take approximately 20 minutes to travel down 152nd Street to our office from 104th Avenue.

INSIGHTFUL ➤ INTIMATE ➤ INFORMATIVE ➤ INSPIRED



Christine LaLiberté, CIM, FCSI, Senior Investment Advisor,  
Director, Private Client Group, DWM Securities Inc.  
309 - 5455 152nd Street, Surrey, B.C. V3S 5A5  
T. 604-575-6911 claliberte@dundeewealth.com  
[www.insightfulwealthsolutions.com](http://www.insightfulwealthsolutions.com)

